



INSTALLATION GUIDE

安装说明书

This installation guide is applicable for ICE WIND and ICE WIND FS.
此说明书适用于九州风神冰风和冰风旗舰版。

CAUTION:

- 1. All specifications subject to change without notice.
- 2. Under no condition shall Deepcool be liable for any indirect, incidental or consequential damages arising from any defect or error in this manual or product.
- 3. Please ask for professional help if you are not sure of safe installation.
- 4. Installation manual in other languages is available on our website: www.deepcoolglobal.com.

警告声明:

- 1. 本公司有权在未事先通知的情况下对本说明书进行修改，以便改进产品的稳定性、设计及功能。
- 2. 本说明书之描述内容不代表本公司之承诺，对于任何因安装或使用不当而造成直接、间接、有意、无意的损坏及隐患，本公司概不负责。
- 3. 在无法掌握操作方法前需请求专业人士帮助，严禁在未掌握操作要领的前提下使用本产品。
- 4. 若需对本公司产品了解更多信息，请浏览我们的网页：www.deepcoolglobal.com

Beijing Deepcool Industries Co., Ltd.
<http://www.deepcoolglobal.com>
MADE IN CHINA
出品:北京市九州风神科贸有限责任公司
地址:北京市中关村科技园区

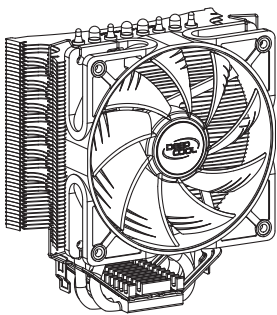

ICE WIND
冰风

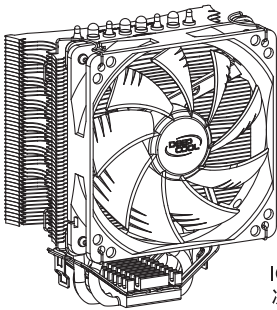

ICE WIND FS
冰风旗舰版

PRODUCT SCHEMATIC DRAWING
产品示意图

COMPONENTS LIST 零部件说明

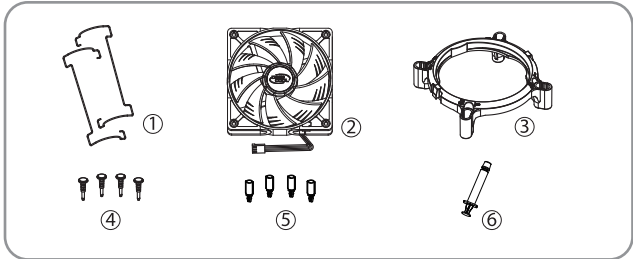

1) Fan Wire Clip 钢丝扣	2 pcs
2) Fan 风扇	1 pc
3) Mounting Bracket 12A转接架	1 pc
4) Push-pin 上扣	4 pcs
5) Clip 下扣	4 pcs
6) Thermal Grease 导热膏	1 pc

INTEL LGA1366/LGA1156/LGA775 Installation 安装步骤

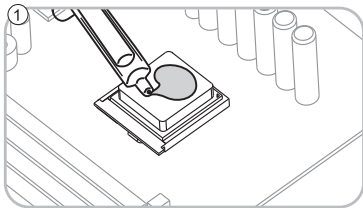

Evenly apply a thin layer of thermal grease onto the processor.
将导热膏均匀涂在CPU表面。

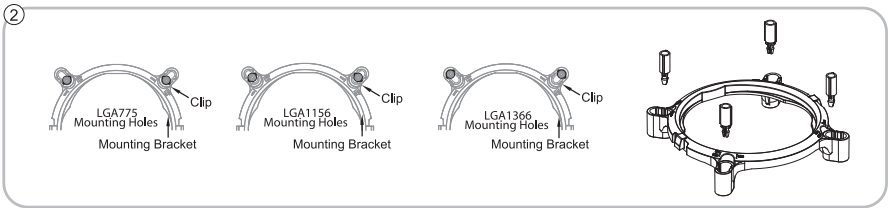

As illustrated, insert the clips into the mounting bracket according to the socket type.
如图，将下扣穿过I2A转接架的相应主板孔位，压紧下扣。

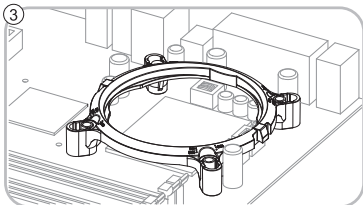

Put the mounting bracket on the motherboard with the clips in the motherboard mounting holes.
将装好下扣的转接架放到主板上，下扣凸出的部分穿过主板相应孔位。

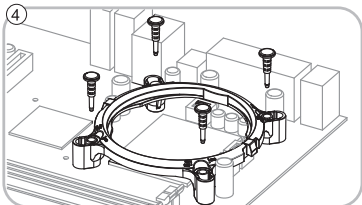

Insert the push-pins into the clips, push them tight until the mounting brackets are safely installed on the motherboard.
将上扣穿过下扣的孔，用力下压扣紧，扣紧后检验I2A转接架安装牢固，无活动现象。

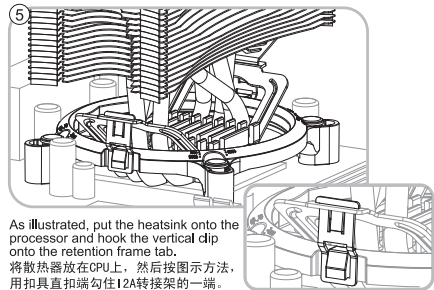

As illustrated, put the heatsink onto the processor and hook the vertical clip onto the retention frame tab.
将散热器放在CPU上，然后按图示方法，用扣具直扣端勾住I2A转接架的一端。

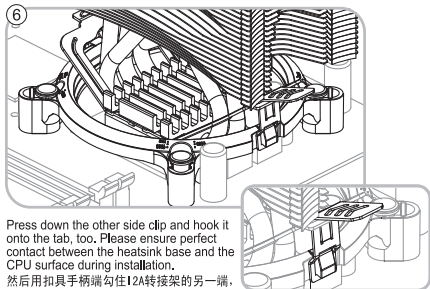

Press down the other side clip and hook it onto the tab, too. Please ensure perfect contact between the heatsink base and the CPU surface during installation.
然后用扣具手柄端勾住I2A转接架的另一端，检查并确认散热器底部与CPU表面完全接触。

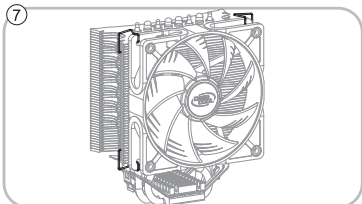

Attach the fan to the heatsink with wire clips.
用钢丝扣把风扇安装固定在散热片组的一侧。

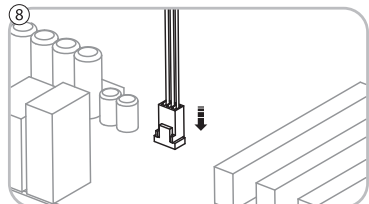

Finish the installation by connecting the fan cable to the motherboard.
将风扇插头插在主板相应位置，确认无误后完成安装。

AMD AM3/AM2+/AM2/K8 Installation 安装步骤

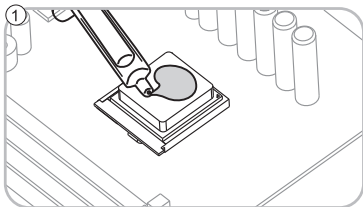

Evenly apply a thin layer of thermal grease onto the processor.
将导热膏均匀涂在CPU表面。

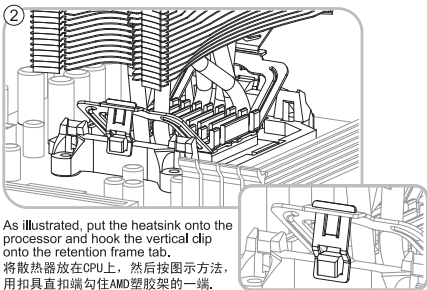

As illustrated, put the heatsink onto the processor and hook the vertical clip onto the retention frame tab.
将散热器放在CPU上，然后按图示方法，用扣具直扣端勾住AMD塑胶架的一端。

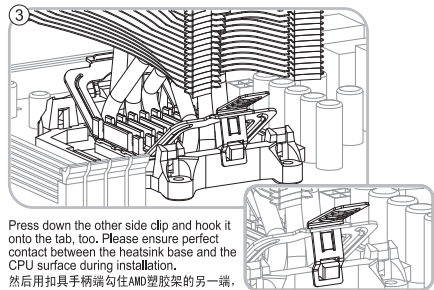

Press down the other side clip and hook it onto the tab, too. Please ensure perfect contact between the heatsink base and the CPU surface during installation.
然后用扣具手柄端勾住AMD塑胶架的另一端，检查并确认散热器底部与CPU表面完全接触。

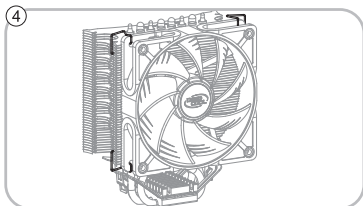

Attach the fan to the heatsink with wire clips.
用钢丝扣把风扇安装固定在散热片组的一侧。

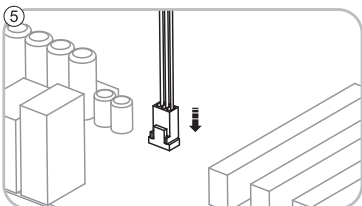

Finish the installation by connecting the fan cable to the motherboard.
将风扇插头插在主板相应位置，确认无误后完成安装。